

# TREMPRO 160

## Table of Contents

R-BG-01 (PDF): Residential at Below Grade - EN

1

R-BG-P-01 (PDF): Residential Below Grade Penetration - EN

2

R-T-01 (PDF): Residential Below Grade to Above Grade Transition - EN

3

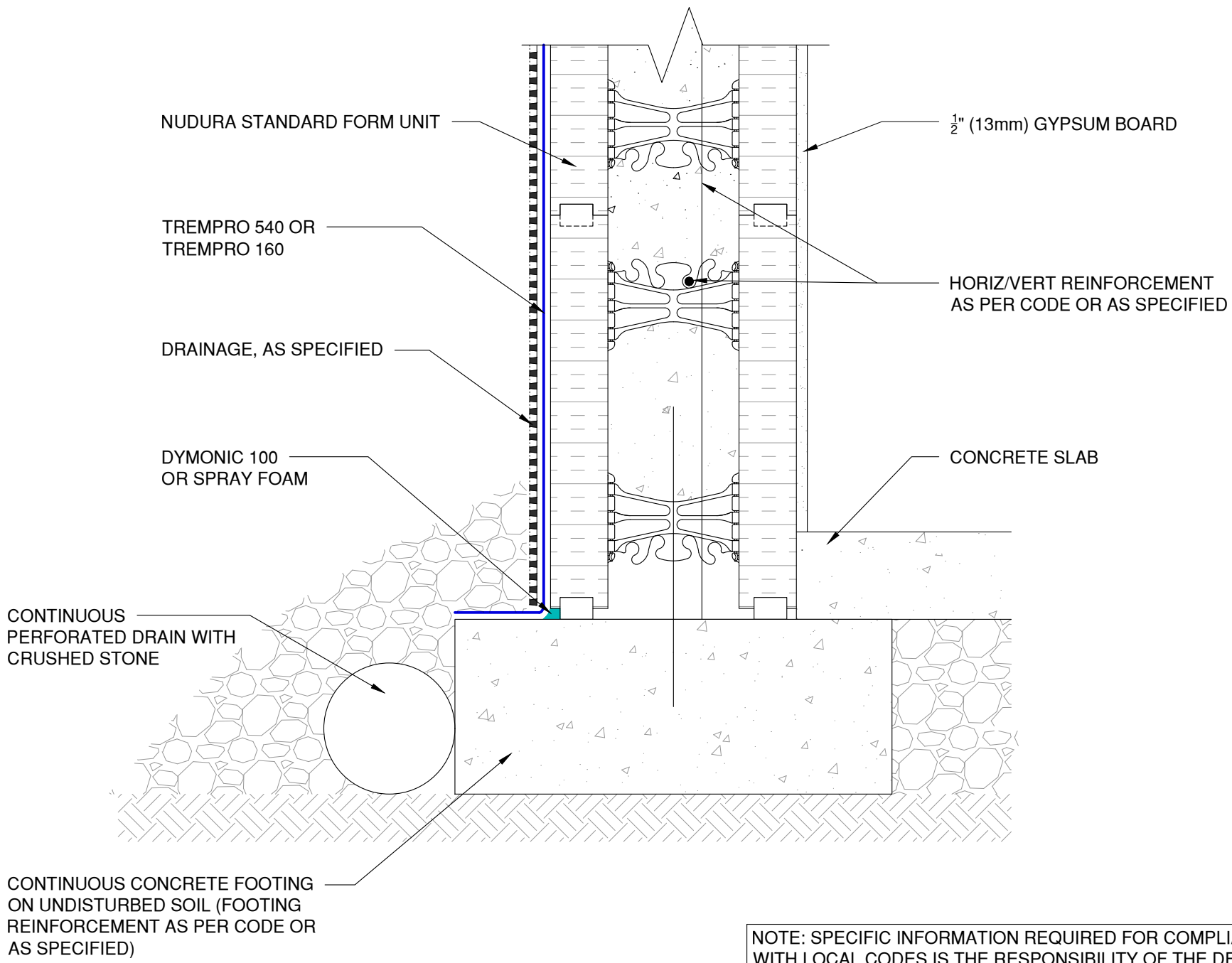

NOTE: SPECIFIC INFORMATION REQUIRED FOR COMPLIANCE WITH LOCAL CODES IS THE RESPONSIBILITY OF THE DESIGNER



Project:  
Detail: Residential at Below Grade

File Name:  
R-BG-01

This detail is intended for conceptual purposes only. Drawn by: KAB Checked by: KS/RW/JS/CB Scale: NTS Date: 12/1/2020

NOTE: SPECIFIC INFORMATION REQUIRED FOR COMPLIANCE WITH LOCAL CODES IS THE RESPONSIBILITY OF THE DESIGNER

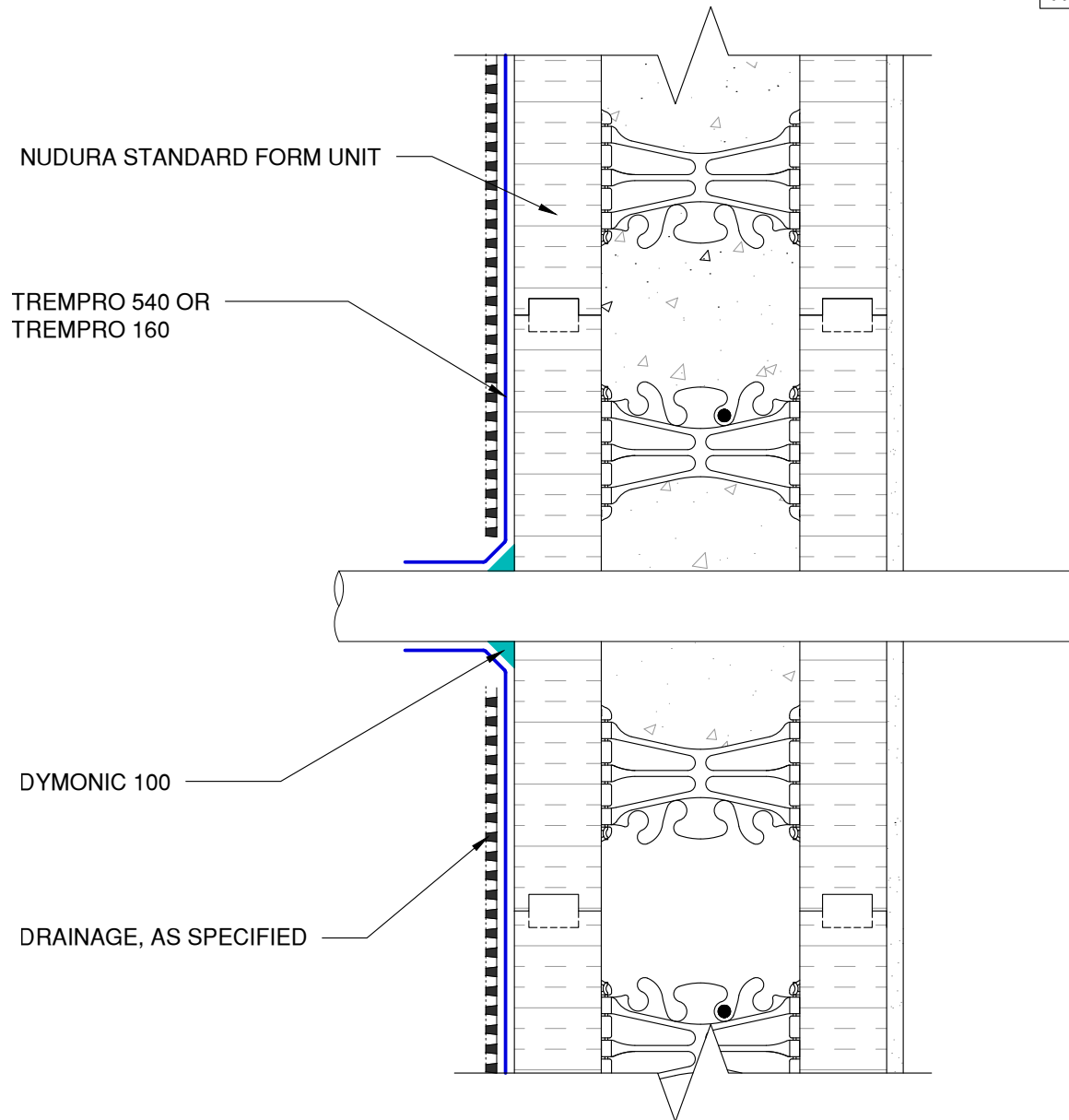

EXTERIOR FINISH AS SPECIFIED

HORIZ/VERT REINFORCEMENT AS PER CODE OR AS SPECIFIED

WET SET DOWELS TO MATCH VERTICAL REINFORCEMENT BETWEEN POUR OR AS SPECIFIED

ENVIRO-DRI

FINISH GRADE MINIMUM 6" (152mm) OR AS PER CODE

2-3" MIN.

$\frac{3}{16}$ " (5mm) ACRYLIC PARGE COAT OR OTHER APPROVED EPS COMPATIBLE FINISH

TREMPRO 160

DRAINAGE, AS SPECIFIED

$\frac{1}{2}$ " (13mm) GYPSUM BOARD

BLOCKING BETWEEN JOISTS

JOISTS/TRUSSES AS SPECIFIED

$\frac{1}{2}$ " (13mm) GYPSUM BOARD

PROPRIETARY EMBEDDED JOIST ANCHORAGE SYSTEM OR EQUIVALENT

NUDURA STANDARD FORM UNIT

$\frac{1}{2}$ " (13mm) GYPSUM BOARD

NOTE: SPECIFIC INFORMATION REQUIRED FOR COMPLIANCE WITH LOCAL CODES IS THE RESPONSIBILITY OF THE DESIGNER